



Office Building For Sale

Little Rd - Medical / Retail Shell Space

5089 Little Rd, New Port Richey, FL 34655

For More Information:

813-254-6756 | EXT 22

Michael Braccia, P.A. | mike@baystreetcommercial.com

Scott Shimberg | scott@baystreetcommercial.com





Little Rd - Medical / Retail Shell Space

5089 Little Rd, New Port Richey, FL 34655

Executive Summary



OFFERING SUMMARY

| | |
|----------------|---------------------------------------|
| Available SF: | 0 SF |
| Lease Rate: | Negotiable |
| Lot Size: | 81,829 SF |
| Year Built: | 2022 |
| Building Size: | 4,991 SF |
| Zoning: | C2 |
| Market: | Tampa-St Petersburg- Clearwater |
| Traffic Count: | 40,000 |

PROPERTY OVERVIEW

This 4,991 SF Little Road medical office has been recently leased to Baycare Medical Group for a new 7 year term and the tenant has recently completed their interior tenant improvements for a primary care medical facility. Lease commencement was June 27, 2022 and the expiration date is June 30, 2029. This medical condo unit, Unit B, is located within a 9,982 SF building (Units A & B). The condominium consists of three (3) Units; Units A, B and C. This 1.88 acre condominium complex offers a 6 space per 1000 SF parking ratio, making it ideal for high traffic practitioners as the site is located seconds from River Crossings Shopping Center, one of the busiest Publix shopping centers in the area. Other neighbors include Starbucks, McDonalds, Monticciolo Family Dentistry, Prestige Dermatology, Verizon Wireless, and Dunkin Donuts. The Year 1 Net Operating Income is \$99,820 with 3% annual escalation throughout term with no rent holiday. The tenant funded their own interior buildout and enjoys a below market rent; offering added longterm security to a new owner.

LOCATION OVERVIEW

Located in the New Port Richey area east of US 19 and north of State Road 54 with close proximity to the Suncoast, offering easy access to all surrounding areas.



Little Rd - Medical / Retail Shell Space

5089 Little Rd, New Port Richey, FL 34655

Additional Photos



Bay Street Commercial | 611 West Bay Street | Tampa, FL 33606 | 813.625.2375 | www.baystreetcommercial.com

3

For More Information:

813-254-6756 | EXT 22

Property Webpage: www.properties.baystreetcommercial.com/525798-lease

Michael Braccia, P.A. | mike@baystreetcommercial.com

Scott Shimberg | scott@baystreetcommercial.com





Little Rd - Medical / Retail Shell Space

5089 Little Rd, New Port Richey, FL 34655

Additional Photos

For More Information:

813-254-6756 | EXT 22

Property Webpage: www.properties.baystreetcommercial.com/525798-lease

Michael Braccia, P.A. | mike@baystreetcommercial.com

Scott Shimberg | scott@baystreetcommercial.com



Little Rd - Medical / Retail Shell Space

5089 Little Rd, New Port Richey, FL 34655

Floor Plans

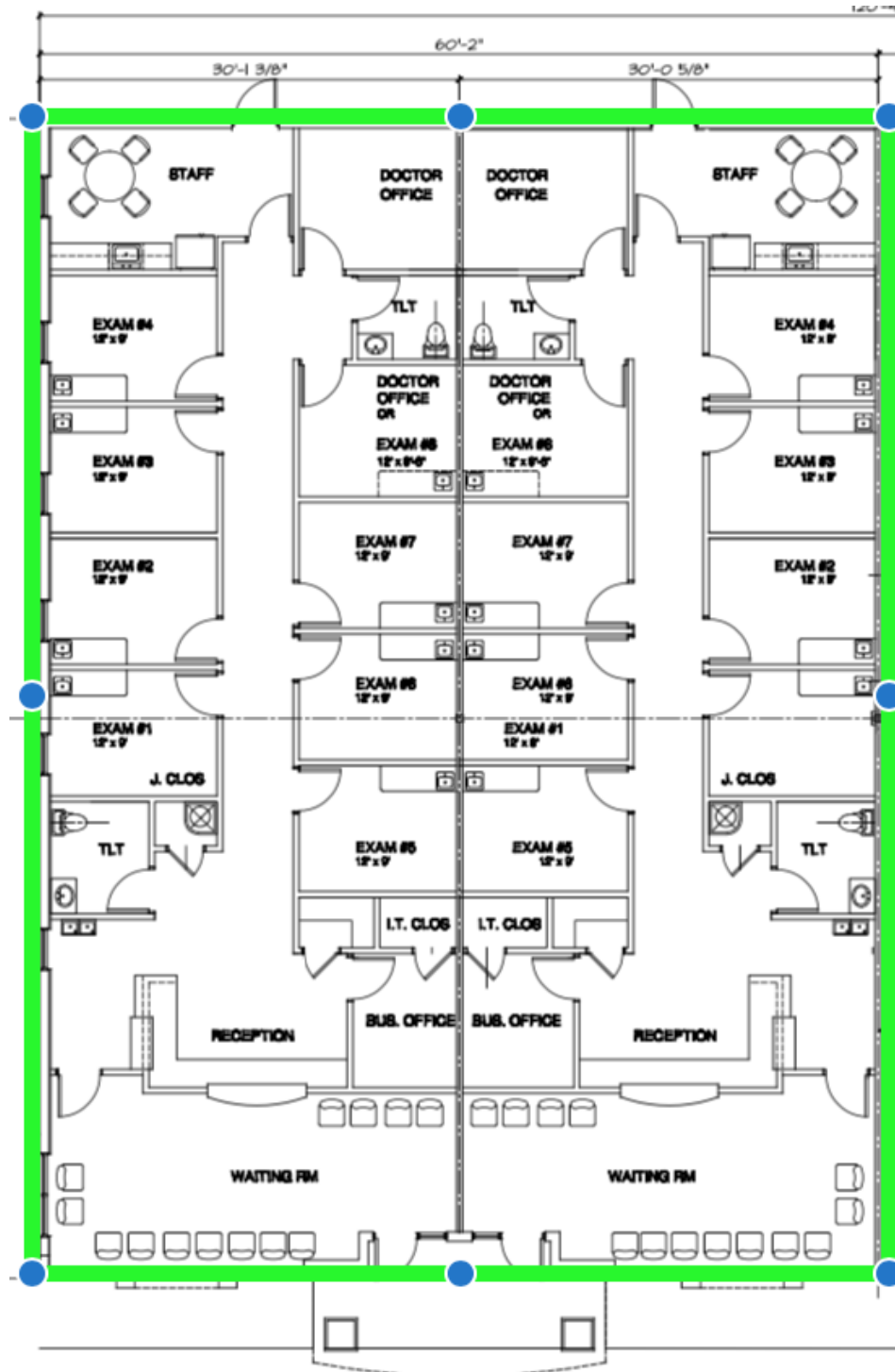



Little Rd - Medical / Retail Shell Space

5089 Little Rd, New Port Richey, FL 34655

Site Plan

For More Information:

813-254-6756 | EXT 22

Property Webpage: www.properties.baystreetcommercial.com/525798-lease

Michael Braccia, P.A. | mike@baystreetcommercial.com

Scott Shimberg | scott@baystreetcommercial.com



Little Rd - Medical / Retail Shell Space

5089 Little Rd, New Port Richey, FL 34655

Location Maps

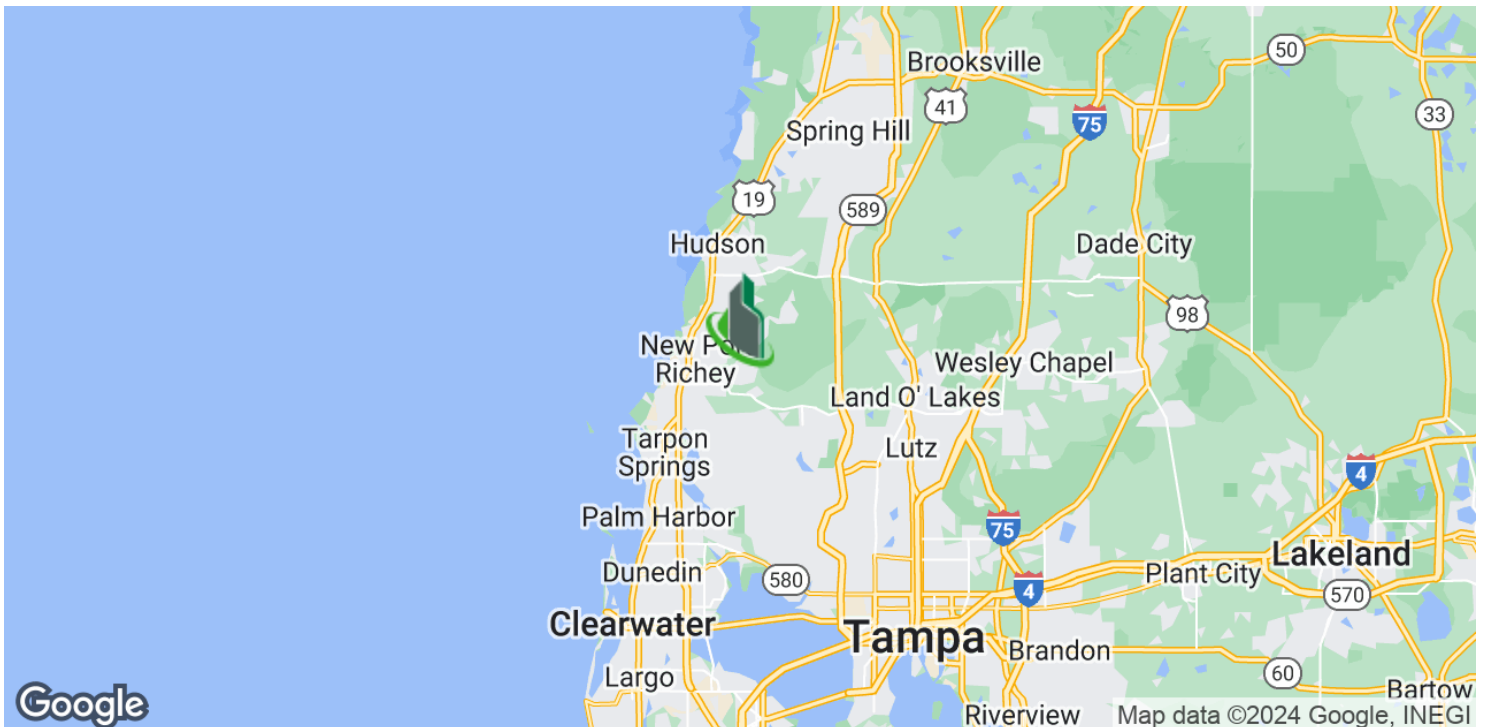
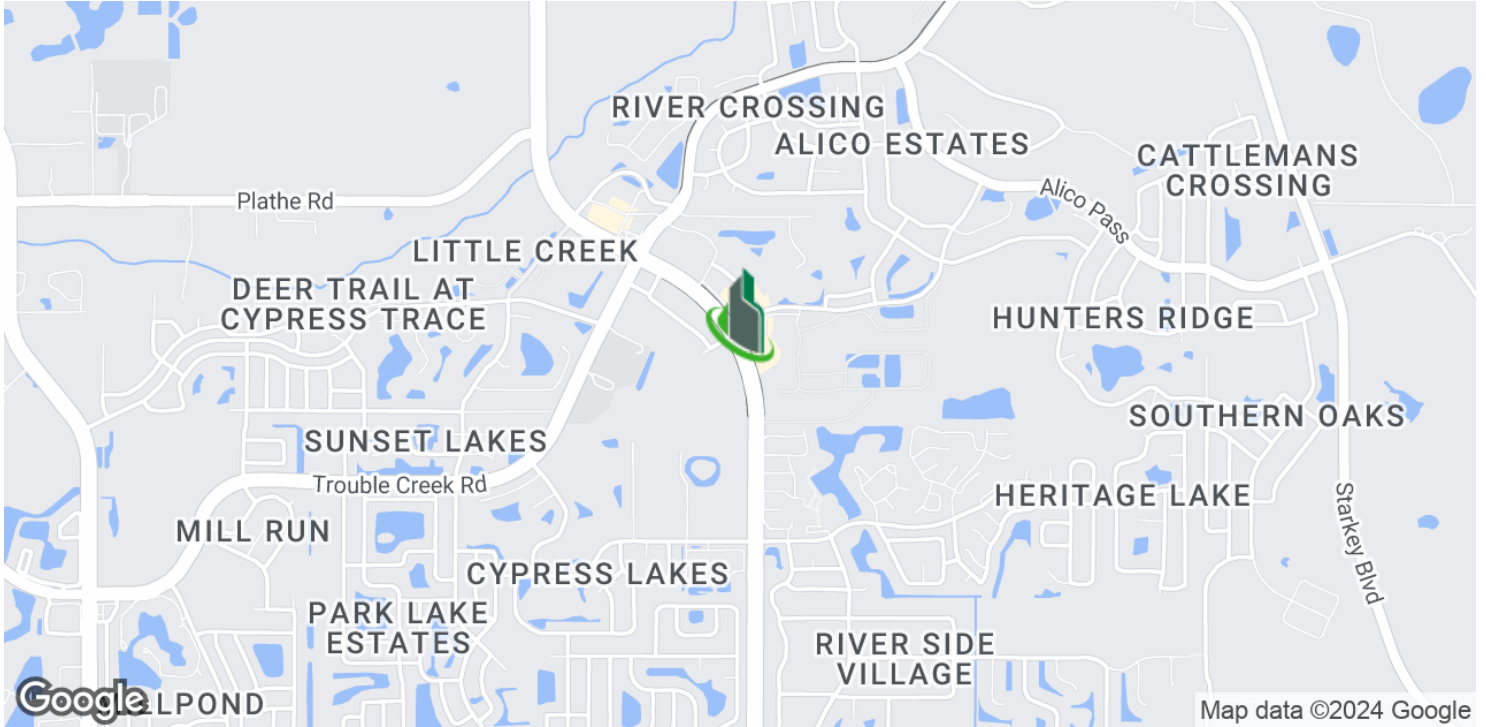

Bay Street Commercial | 611 West Bay Street | Tampa, FL 33606 | 813.625.2375 | www.baystreetcommercial.com

7

For More Information:

813-254-6756 | EXT 22

Property Webpage: www.properties.baystreetcommercial.com/525798-lease

Michael Braccia, P.A. | mike@baystreetcommercial.com

Scott Shimberg | scott@baystreetcommercial.com





Little Rd - Medical / Retail Shell Space

5089 Little Rd, New Port Richey, FL 34655

Demographics Map & Report

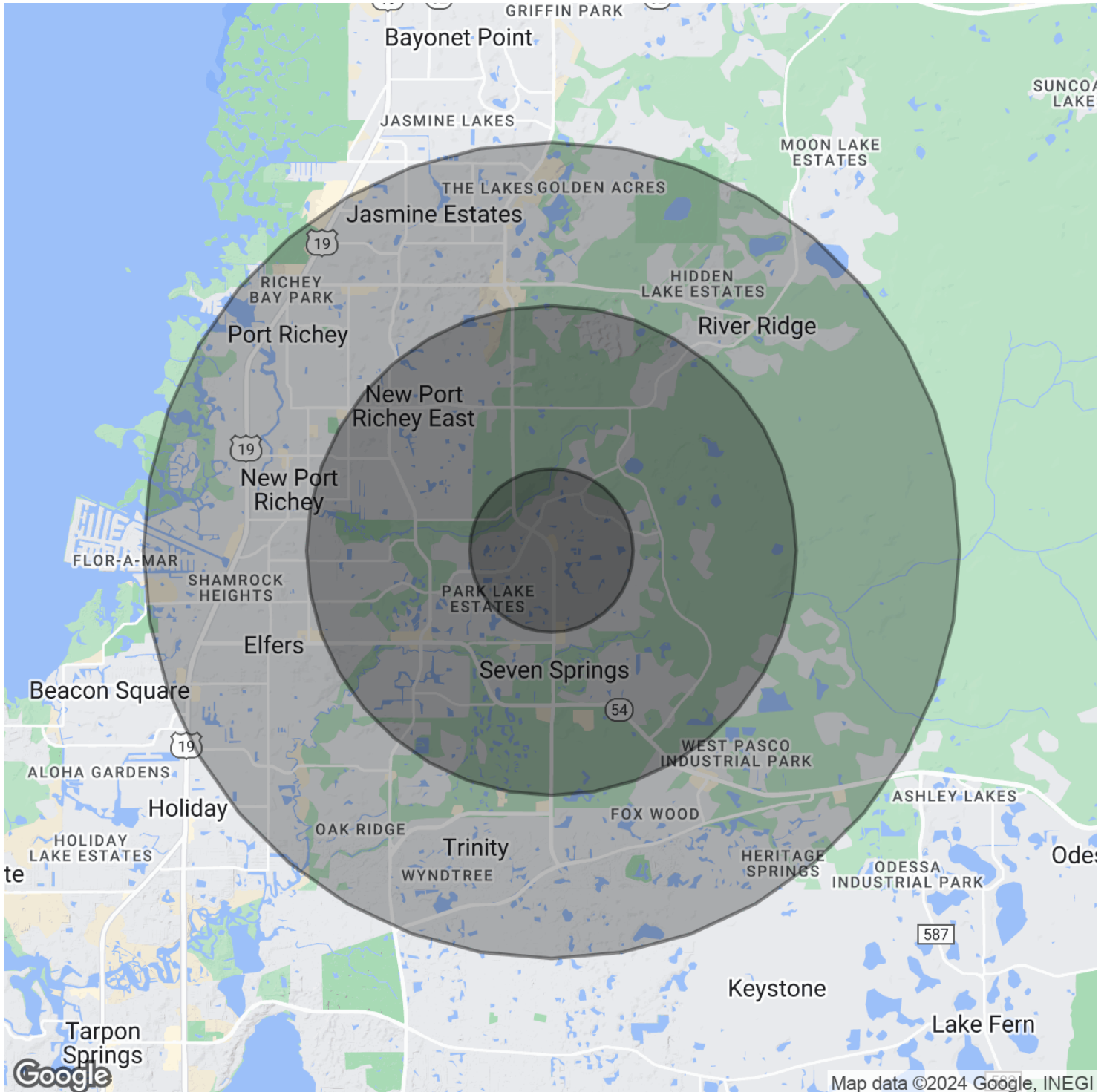

Bay Street Commercial | 611 West Bay Street | Tampa, FL 33606 | 813.625.2375 | www.baystreetcommercial.com

8

For More Information:

813-254-6756 | EXT 22

Property Webpage: www.properties.baystreetcommercial.com/525798-lease

Michael Braccia, P.A. | mike@baystreetcommercial.com

Scott Shimberg | scott@baystreetcommercial.com





Little Rd - Medical / Retail Shell Space

5089 Little Rd, New Port Richey, FL 34655

Demographics Map & Report

POPULATION

| | 1 MILE | 3 MILES | 5 MILES |
|---------------------|--------|---------|---------|
| Total Population | 7,945 | 50,413 | 132,431 |
| Median age | 51.0 | 48.0 | 44.4 |
| Median age (Male) | 50.6 | 46.4 | 42.7 |
| Median age (Female) | 50.7 | 49.3 | 45.6 |

HOUSEHOLDS & INCOME

| | 1 MILE | 3 MILES | 5 MILES |
|---------------------|-----------|-----------|-----------|
| Total households | 3,509 | 21,710 | 55,829 |
| # of persons per HH | 2.3 | 2.3 | 2.4 |
| Average HH income | \$57,074 | \$56,282 | \$54,763 |
| Average house value | \$195,348 | \$209,612 | \$206,565 |

ETHNICITY (%)

| | 1 MILE | 3 MILES | 5 MILES |
|----------|--------|---------|---------|
| Hispanic | 4.2% | 6.4% | 8.0% |

RACE

| | 1 MILE | 3 MILES | 5 MILES |
|------------------------------------|--------|---------|---------|
| Total Population - White | 7,499 | 46,780 | 122,786 |
| % White | 94.4% | 92.8% | 92.7% |
| Total Population - Black | 60 | 861 | 2,904 |
| % Black | 0.8% | 1.7% | 2.2% |
| Total Population - Asian | 218 | 1,192 | 2,644 |
| % Asian | 2.7% | 2.4% | 2.0% |
| Total Population - Hawaiian | 0 | 9 | 108 |
| % Hawaiian | 0.0% | 0.0% | 0.1% |
| Total Population - American Indian | 34 | 78 | 287 |
| % American Indian | 0.4% | 0.2% | 0.2% |
| Total Population - Other | 69 | 746 | 1,716 |
| % Other | 0.9% | 1.5% | 1.3% |

TRAFFIC COUNTS

| | |
|------------------------------|------------|
| Little Rd & Trouble Creek Rd | 40,000/day |
|------------------------------|------------|